

XXL型同步带齿形图

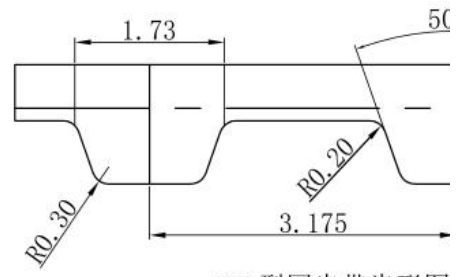

XXL型同步带齿形图

规格 Belt Type	节线长 Pitch Length	齿数 Teeth Number
82.5XXL	209.55	66
110XXL	279.4	88
112XXL	284.48	90
141XXL	358.14	113

规格 Belt Type	节线长 Pitch Length
155XXL	393.7
163XXL	414.02
187.5XXL	476.25

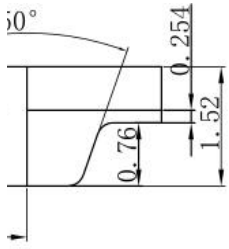

图

齿数 Teeth Number
124
130
150